

THIRD ANGLE PROJECTION

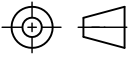

FOR GUIDANCE ONLY
THIS INFORMATION HAS BEEN
PROVIDED IN GOOD FAITH BUT
SPECIFICATIONS DO CHANGE

Edition B

Date 06/07/10

Scale 1:1 @ A4

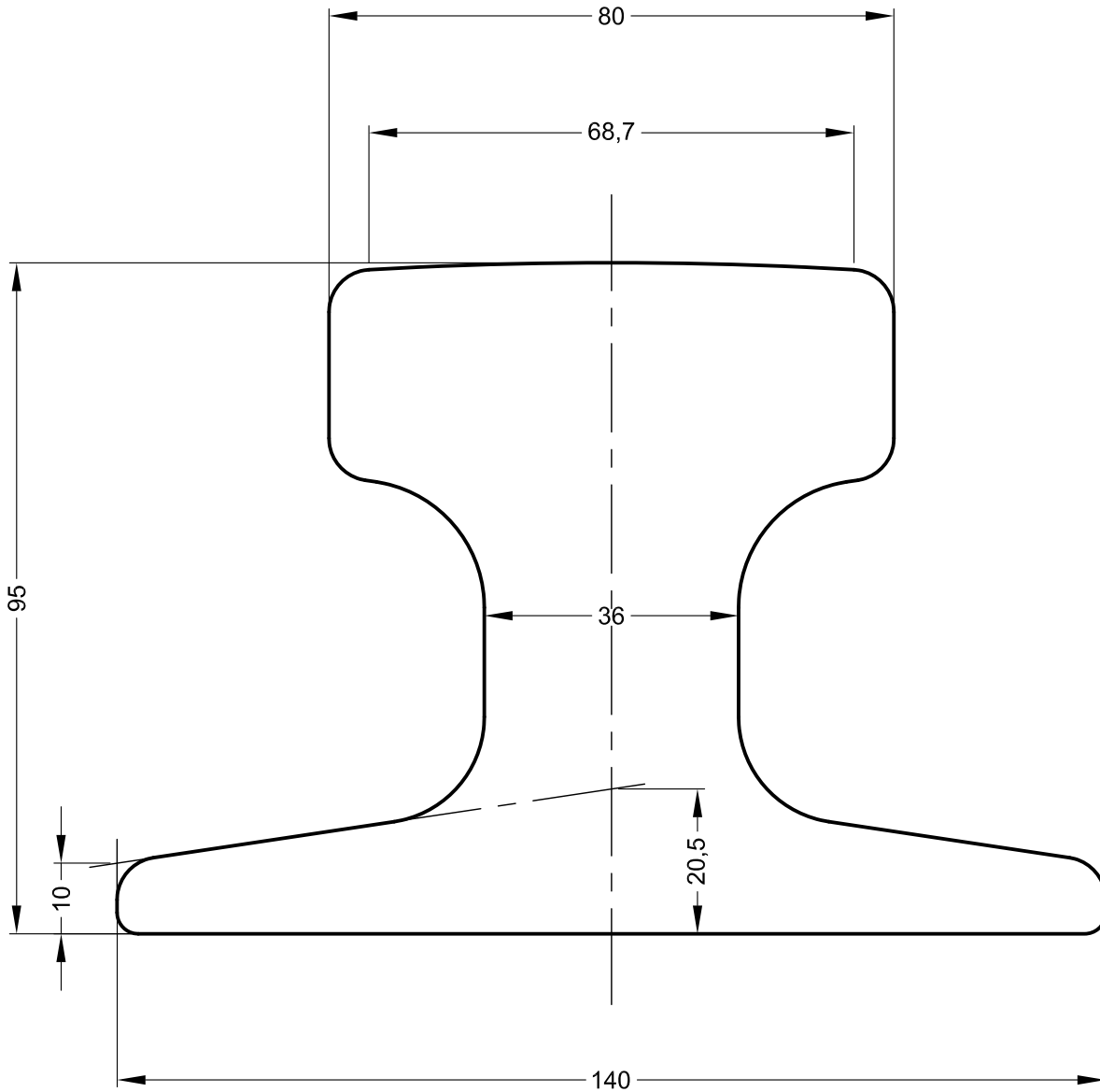

NOTE: THE PROPERTIES SPECIFIED BELOW HAVE BEEN CALCULATED USING AUTOCAD SOFTWARE AND ARE ACCURATE AT THE TIME OF THIS DRAWING ISSUE. THESE FIGURES MAY DIFFER SLIGHTLY FROM THOSE PUBLISHED IN THE STANDARD FOR THE RAIL.

GANTRAIL[®]

Rail Mounting Systems

Gantry Railing Limited
SUDMEADOW ROAD, HEMPSTED
GLOUCESTER GL2 5HG, ENGLAND
Tel: (01452)300688 Fax (01452)300198
International Dialling # 44.1452
<http://www.gantrail.com>
E-Mail: info@gantrail.com

THE TECHNICAL DATA CONTAINED IN THIS DRAWING IS THE PROPERTY
OF GANTRY RAILING LIMITED AND IS SUBJECT TO COPYRIGHT ©

Rail Designation	JKL 80		
Rail Origin	CZECH REPUBLIC		
Standard	UNKNOWN		
Area of section	6349 mm ²		
Calculated Mass	49.9 kg/m		
Neutral Axis to base	44.8 mm		
Moment of Inertia	Ixx	635 cm ⁴	Iyy 433 cm ⁴