

1

2

3

4

THIRD ANGLE PROJECTION

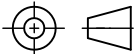

FOR GUIDANCE ONLY
THIS INFORMATION HAS BEEN
PROVIDED IN GOOD FAITH BUT
SPECIFICATIONS DO CHANGE

Edition B

Date 06/07/10

Scale 1:1 @ A4

A

A

B

B

C

C

D

D

E

E

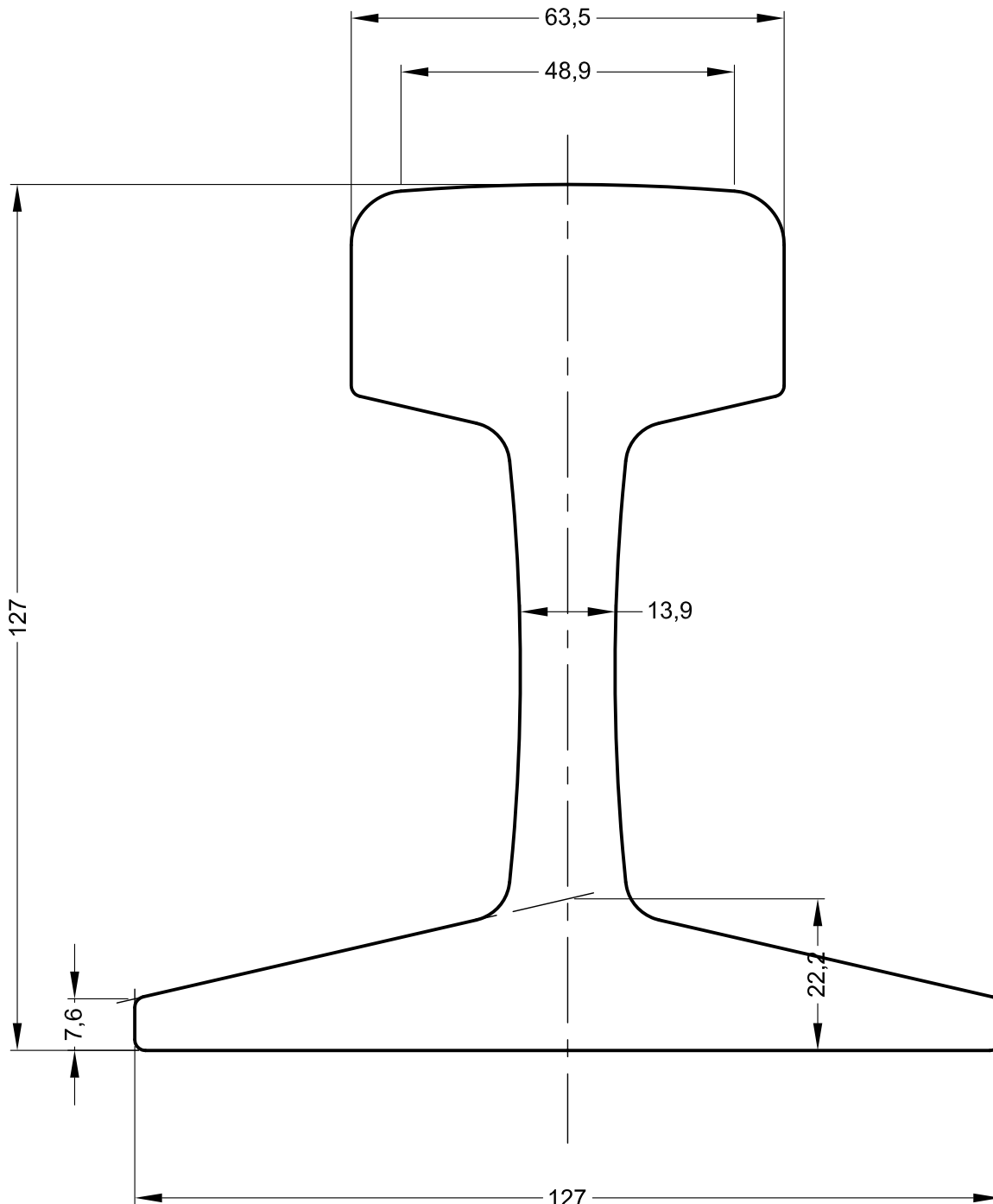

NOTE: THE PROPERTIES SPECIFIED BELOW HAVE BEEN CALCULATED USING AUTOCAD SOFTWARE AND ARE ACCURATE AT THE TIME OF THIS DRAWING ISSUE. THESE FIGURES MAY DIFFER SLIGHTLY FROM THOSE PUBLISHED IN THE STANDARD FOR THE RAIL.

GANTRAIL[®]

Rail Mounting Systems

Gantry Railing Limited

SUDMEADOW ROAD, HEMPSTED
GLOUCESTER GL2 5HG, ENGLAND
Tel: (01452)300688 Fax (01452)300198
International Dialling # 44.1452
<http://www.gantrail.com>
E-Mail: info@gantrail.com

THE TECHNICAL DATA CONTAINED IN THIS DRAWING IS THE PROPERTY
OF GANTRY RAILING LIMITED AND IS SUBJECT TO COPYRIGHT ©

Rail Designation ASCE 80

Rail Origin USA

Standard ASTM A1

Area of section 5078 mm²

Calculated Mass 39.8 kg/m

Neutral Axis to base 60.4 mm

Moment of Inertia I_{xx} 1101 cm⁴ I_{yy} 259 cm⁴

1

4

F

F